

E-LINE CTK

CABLE TRAY SYSTEMS



Hot Dip Galvanized
CTK Snap-on Cover
Cable Tray Systems



CTK

E-Line CTK

Cable Trays and Modules

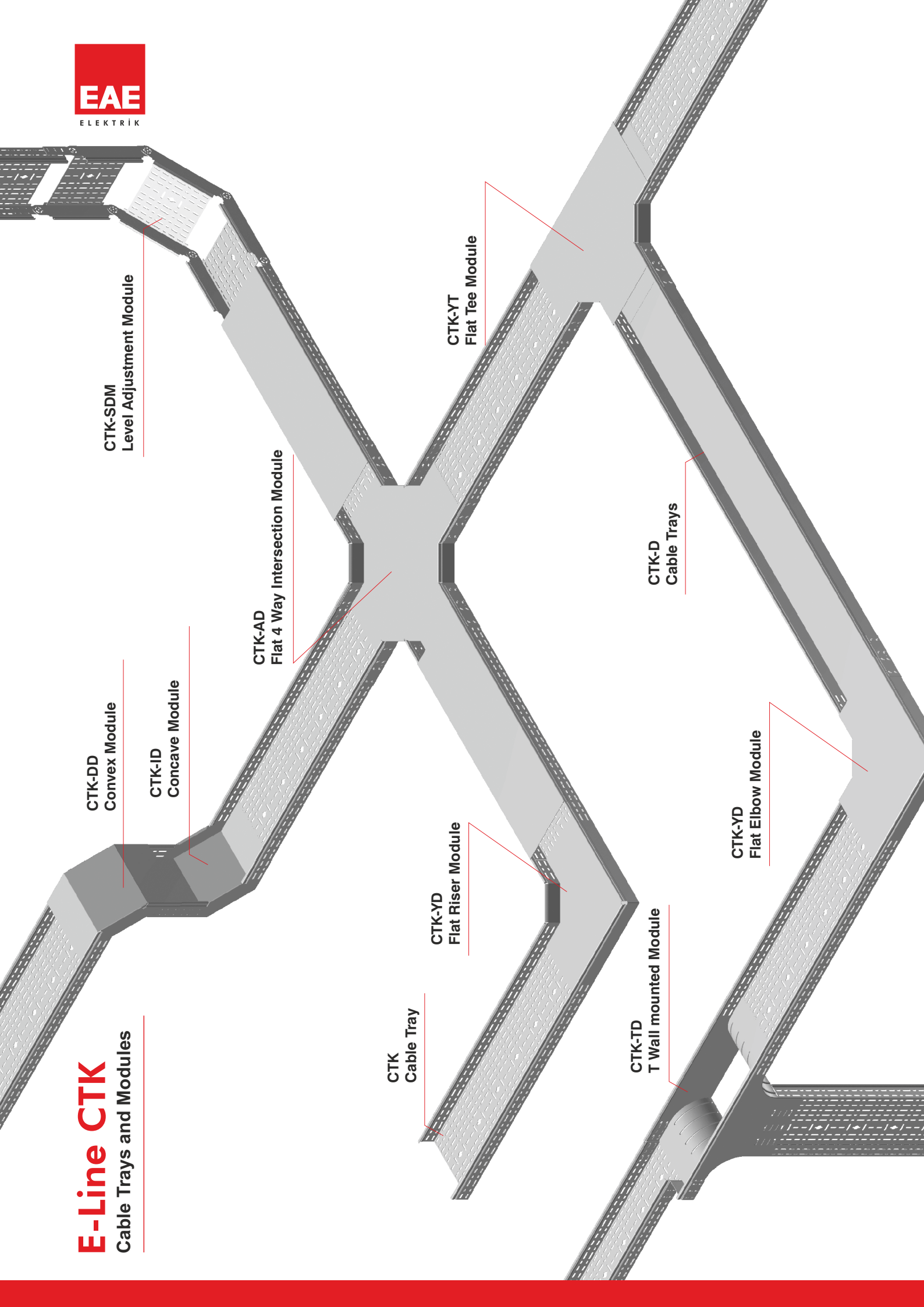

CTK-SDM
Level Adjustment Module

CTK-YT
Flat Tee Module

CTK-AD
Flat 4 Way Intersection Module

CTK-D
Cable Trays

CTK-DD
Convex Module

CTK-ID
Concave Module

CTK-YD
Flat Riser Module

CTK-YD
Flat Elbow Module

CTK
Cable Tray

CTK-TD
T Wall mounted Module

CONTENTS

| | |
|--------------|---|
| 2 | CTK Cable Tray |
| 3 | CTK-D Cable Tray |
| 4-11 | CTK Cable Tray Modules |
| 12 | CTK Joint Fitting |
| 13 | CTK Level Adaptation Module |
| 14 | CTK Level Adaptation Joint, Hinged Joint, Separator |
| 15-17 | CTK Reduction |
| 18 | CTK End Cover |

CABLE TRAYS SYSTEMS

▶▶ CTK CABLE TRAYS

Hot Dip Galvanized After Fabrication (TS EN ISO 1461)

| Description | H (mm) | A (mm) | T (mm) | Weight (kg./m) | Order Code |
|---------------|--------|--------|--------|----------------|------------|
| 060 CTK 100 | 60 | 100 | 1,5 | 2,674 | 2002142 |
| CTK 100 COVER | | 100 | 1,5 | 1,810 | 2002190 |
| 060 CTK 150 | 60 | 150 | 1,5 | 3,204 | 2002143 |
| CTK 150 COVER | | 150 | 1,5 | 2,456 | 2002191 |
| 060 CTK 200 | 60 | 200 | 1,5 | 3,720 | 2002144 |
| CTK 200 COVER | | 200 | 1,5 | 3,104 | 2002192 |
| 060 CTK 250 | 60 | 250 | 1,5 | 4,252 | 2002145 |
| CTK 250 COVER | | 250 | 1,5 | 3,752 | 2002193 |
| 060 CTK 300 | 60 | 300 | 1,5 | 4,782 | 2002146 |
| CTK 300 COVER | | 300 | 1,5 | 4,337 | 2002194 |
| 060 CTK 400 | 60 | 400 | 2 | 7,969 | 2002147 |
| CTK 400 COVER | | 400 | 2 | 7,593 | 2002195 |
| 060 CTK 500 | 60 | 500 | 2 | 9,225 | 2002148 |
| CTK 500 COVER | | 500 | 2 | 9,321 | 2002196 |
| 060 CTK 600 | 60 | 600 | 2 | 10,641 | 2002149 |
| CTK 600 COVER | | 600 | 2 | 11,046 | 2002197 |
| <hr/> | | | | | |
| 075 CTK 100 | 75 | 100 | 1,5 | 2,946 | 2002150 |
| CTK 100 COVER | | 100 | 1,5 | 1,810 | 2002190 |
| 075 CTK 150 | 75 | 150 | 1,5 | 3,476 | 2002151 |
| CTK 150 COVER | | 150 | 1,5 | 2,456 | 2002191 |
| 075 CTK 200 | 75 | 200 | 1,5 | 4,007 | 2002152 |
| CTK 200 COVER | | 200 | 1,5 | 3,104 | 2002192 |
| 075 CTK 250 | 75 | 250 | 1,5 | 4,538 | 2002153 |
| CTK 250 COVER | | 250 | 1,5 | 3,752 | 2002193 |
| 075 CTK 300 | 75 | 300 | 1,5 | 5,069 | 2002154 |
| CTK 300 COVER | | 300 | 1,5 | 4,337 | 2002194 |
| 075 CTK 400 | 75 | 400 | 2 | 8,173 | 2002155 |
| CTK 400 COVER | | 400 | 2 | 7,593 | 2002195 |
| 075 CTK 500 | 75 | 500 | 2 | 9,586 | 2002156 |
| CTK 500 COVER | | 500 | 2 | 9,321 | 2002196 |
| 075 CTK 600 | 75 | 600 | 2 | 11,002 | 2002157 |
| CTK 600 COVER | | 600 | 2 | 11,046 | 2002197 |

Cable Trays

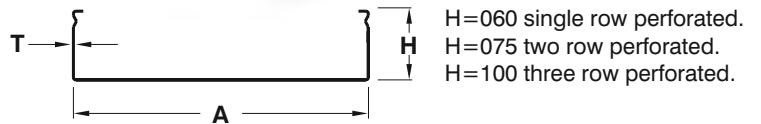
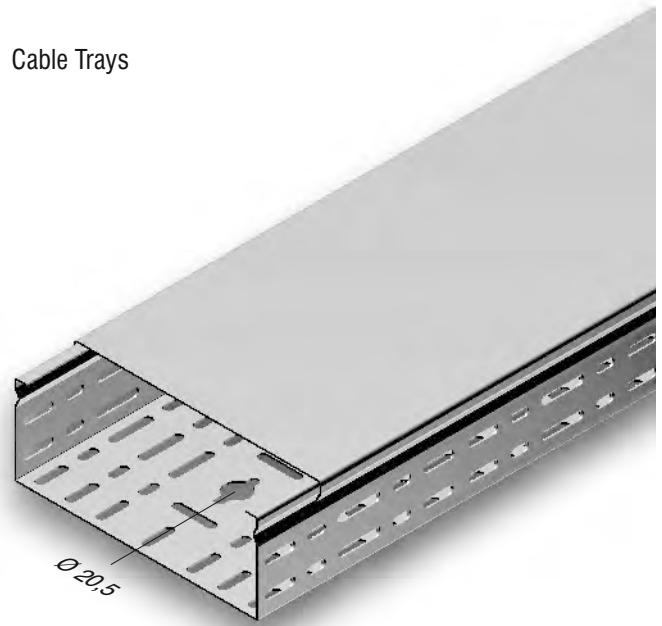

| Description | H (mm) | A (mm) | T (mm) | Weight (kg./m) | Order Code |
|---------------|--------|--------|--------|----------------|------------|
| 100 CTK 100 | 100 | 100 | 1,5 | 3,476 | 2002158 |
| CTK 100 COVER | | 100 | 1,5 | 1,810 | 2002190 |
| 100 CTK 150 | 100 | 150 | 1,5 | 4,007 | 2002159 |
| CTK 150 COVER | | 150 | 1,5 | 2,456 | 2002191 |
| 100 CTK 200 | 100 | 200 | 1,5 | 4,538 | 2002160 |
| CTK 200 COVER | | 200 | 1,5 | 3,104 | 2002192 |
| 100 CTK 250 | 100 | 250 | 1,5 | 5,069 | 2002161 |
| CTK 250 COVER | | 250 | 1,5 | 3,752 | 2002193 |
| 100 CTK 300 | 100 | 300 | 1,5 | 5,619 | 2002162 |
| CTK 300 COVER | | 300 | 1,5 | 4,337 | 2002194 |
| 100 CTK 400 | 100 | 400 | 2 | 8,881 | 2002163 |
| CTK 400 COVER | | 400 | 2 | 7,593 | 2002195 |
| 100 CTK 500 | 100 | 500 | 2 | 10,322 | 2002164 |
| CTK 500 COVER | | 500 | 2 | 9,321 | 2002196 |
| 100 CTK 600 | 100 | 600 | 2 | 11,712 | 2002165 |
| CTK 600 COVER | | 600 | 2 | 11,046 | 2002197 |

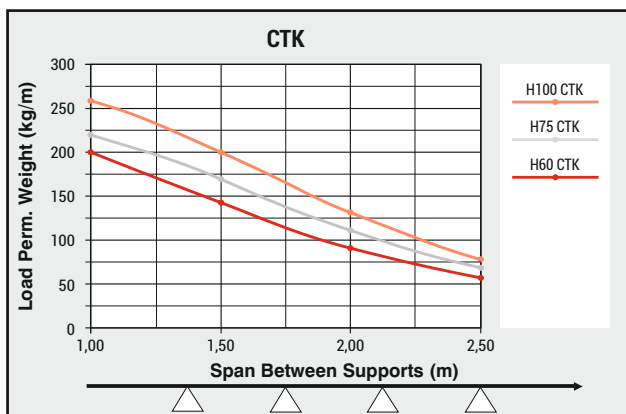

■ Load Perm. Weight may change +/- according to the sheet tolerance and hardness.

Please contact to your customer representative for detailed information.

Sample Order:

Height (H): 100 mm,
Width (A): 200 mm,
Sheet Thickness (T): 1,5 mm,
Coating Type (S): Hot Dip Galvanized,
Module Type: Cable Trays.

- Standard Length 3000 mm.
- For special orders and specifications please contact us.
- Please state the order code when ordering.
- Material weights may vary by ± 10%

▶▶ CTK-D CABLE TRAYS

Hot Dip Galvanized After Fabrication (TS EN ISO 1461)

| Description | H (mm) | A (mm) | T (mm) | Weight (kg./m) | Order Code |
|-----------------|--------|--------|--------|----------------|------------|
| 060 CTK-D 100 | 60 | 100 | 1,5 | 2,993 | 2002166 |
| CTK-D 100 COVER | | 100 | 1,5 | 1,810 | 2002190 |
| 060 CTK-D 150 | 60 | 150 | 1,5 | 3,641 | 2002167 |
| CTK-D 150 COVER | | 150 | 1,5 | 2,456 | 2002191 |
| 060 CTK-D 200 | 60 | 200 | 1,5 | 4,289 | 2002168 |
| CTK-D 200 COVER | | 200 | 1,5 | 3,104 | 2002192 |
| 060 CTK-D 250 | 60 | 250 | 1,5 | 4,937 | 2002169 |
| CTK-D 250 COVER | | 250 | 1,5 | 3,752 | 2002193 |
| 060 CTK-D 300 | 60 | 300 | 1,5 | 5,584 | 2002170 |
| CTK-D 300 COVER | | 300 | 1,5 | 4,337 | 2002194 |
| 060 CTK-D 400 | 60 | 400 | 2 | 9,332 | 2002171 |
| CTK-D 400 COVER | | 400 | 2 | 7,593 | 2002195 |
| 060 CTK-D 500 | 60 | 500 | 2 | 10,899 | 2002172 |
| CTK-D 500 COVER | | 500 | 2 | 9,321 | 2002196 |
| 060 CTK-D 600 | 60 | 600 | 2 | 12,627 | 2002173 |
| CTK-D 600 COVER | | 600 | 2 | 11,046 | 2002197 |
| <hr/> | | | | | |
| 075 CTK-D 100 | 75 | 100 | 1,5 | 3,374 | 2002174 |
| CTK-D 100 COVER | | 100 | 1,5 | 1,810 | 2002190 |
| 075 CTK-D 150 | 75 | 150 | 1,5 | 4,022 | 2002175 |
| CTK-D 150 COVER | | 150 | 1,5 | 2,456 | 2002191 |
| 075 CTK-D 200 | 75 | 200 | 1,5 | 4,668 | 2002176 |
| CTK-D 200 COVER | | 200 | 1,5 | 3,104 | 2002192 |
| 075 CTK-D 250 | 75 | 250 | 1,5 | 5,171 | 2002177 |
| CTK-D 250 COVER | | 250 | 1,5 | 3,752 | 2002193 |
| 075 CTK-D 300 | 75 | 300 | 1,5 | 5,964 | 2002178 |
| CTK-D 300 COVER | | 300 | 1,5 | 4,337 | 2002194 |
| 075 CTK-D 400 | 75 | 400 | 2 | 9,679 | 2002179 |
| CTK-D 400 COVER | | 400 | 2 | 7,593 | 2002195 |
| 075 CTK-D 500 | 75 | 500 | 2 | 11,419 | 2002180 |
| CTK-D 500 COVER | | 500 | 2 | 9,321 | 2002196 |
| 075 CTK-D 600 | 75 | 600 | 2 | 13,144 | 2002181 |
| CTK-D 600 COVER | | 600 | 2 | 11,046 | 2002197 |

Non Perforated Cable Tray

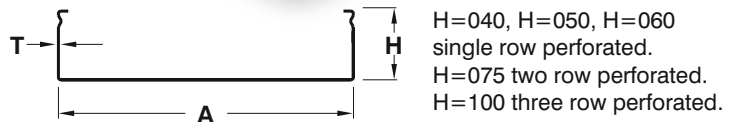
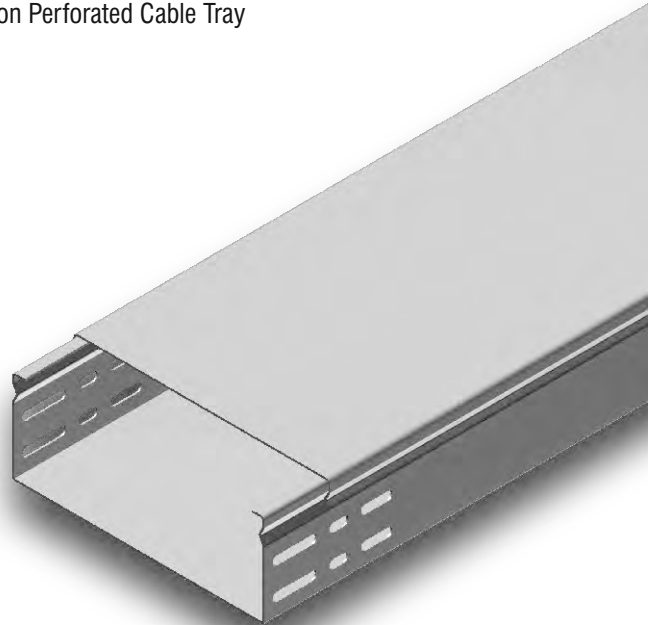

| Description | H (mm) | A (mm) | T (mm) | Weight (kg./m) | Order Code |
|-----------------|--------|--------|--------|----------------|------------|
| 100 CTK-D 100 | 100 | 100 | 1,5 | 4,013 | 2002182 |
| CTK-D 100 COVER | | 100 | 1,5 | 1,810 | 2002190 |
| 100 CTK-D 150 | 100 | 150 | 1,5 | 4,661 | 2002183 |
| CTK-D 150 COVER | | 150 | 1,5 | 2,456 | 2002191 |
| 100 CTK-D 200 | 100 | 200 | 1,5 | 5,308 | 2002184 |
| CTK-D 200 COVER | | 200 | 1,5 | 3,104 | 2002192 |
| 100 CTK-D 250 | 100 | 250 | 1,5 | 5,955 | 2002185 |
| CTK-D 250 COVER | | 250 | 1,5 | 3,752 | 2002193 |
| 100 CTK-D 300 | 100 | 300 | 1,5 | 6,623 | 2002186 |
| CTK-D 300 COVER | | 300 | 1,5 | 4,337 | 2002194 |
| 100 CTK-D 400 | 100 | 400 | 2 | 10,531 | 2002187 |
| CTK-D 400 COVER | | 400 | 2 | 7,593 | 2002195 |
| 100 CTK-D 500 | 100 | 500 | 2 | 12,247 | 2002188 |
| CTK-D 500 COVER | | 500 | 2 | 9,321 | 2002196 |
| 100 CTK-D 600 | 100 | 600 | 2 | 14,020 | 2002189 |
| CTK-D 600 COVER | | 600 | 2 | 11,046 | 2002197 |

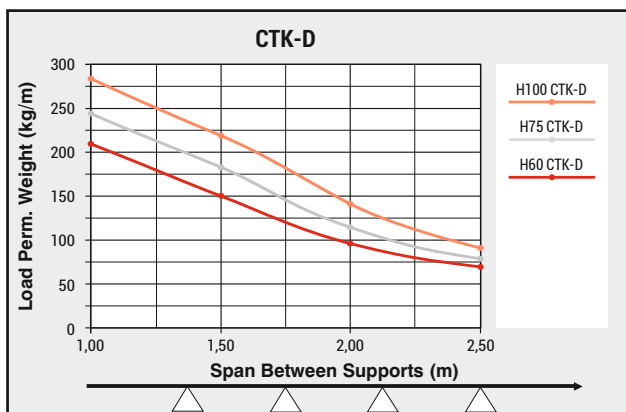

■ Load Perm. Weight may change +/- according to the sheet tolerance and hardness.
Please contact to your customer representative for detailed information.

Sample Order:

Height (H): 75 mm,
Width (A): 500 mm,
Sheet Thickness (T): 1,5 mm,
Coating Type (S): Hot Dip Galvanized,
Module Type: Non perforated cable tray

- Standard Length 3000 mm.
- For special orders and specifications please contact us.
- Please state the order code when ordering.
- Material weights may vary by ± 10%

▶▶ CTK FLAT ELBOW MODULE (45°)

Hot Dip Galvanized After Fabrication (TS EN ISO 1461)

| Description | H (mm) | A (mm) | T (mm) | Weight (kg/m) | Order Code |
|--------------------|--------|--------|--------|---------------|------------|
| 060 CTK 100 YD 45° | 60 | 100 | 1,5 | 2,225 | 3006490 |
| 060 CTK 150 YD 45° | 60 | 150 | 1,5 | 2,930 | 3006491 |
| 060 CTK 200 YD 45° | 60 | 200 | 1,5 | 3,672 | 3006492 |
| 060 CTK 250 YD 45° | 60 | 250 | 1,5 | 4,498 | 3006493 |
| 060 CTK 300 YD 45° | 60 | 300 | 1,5 | 6,043 | 3006494 |
| 060 CTK 400 YD 45° | 60 | 400 | 1,5 | 8,234 | 3006495 |
| 060 CTK 500 YD 45° | 60 | 500 | 1,5 | 10,674 | 3006496 |
| 060 CTK 600 YD 45° | 60 | 600 | 1,5 | 13,364 | 3006497 |
| <hr/> | | | | | |
| 075 CTK 100 YD 45° | 75 | 100 | 1,5 | 2,371 | 3006498 |
| 075 CTK 150 YD 45° | 75 | 150 | 1,5 | 3,083 | 3006499 |
| 075 CTK 200 YD 45° | 75 | 200 | 1,5 | 3,832 | 3006500 |
| 075 CTK 250 YD 45° | 75 | 250 | 1,5 | 4,668 | 3006501 |
| 075 CTK 300 YD 45° | 75 | 300 | 1,5 | 6,222 | 3006502 |
| 075 CTK 400 YD 45° | 75 | 400 | 1,5 | 8,426 | 3006503 |
| 075 CTK 500 YD 45° | 75 | 500 | 1,5 | 10,885 | 3006504 |
| 075 CTK 600 YD 45° | 75 | 600 | 1,5 | 13,591 | 3006505 |
| <hr/> | | | | | |
| 100 CTK 100 YD 45° | 100 | 100 | 1,5 | 2,630 | 3006506 |
| 100 CTK 150 YD 45° | 100 | 150 | 1,5 | 3,357 | 3006507 |
| 100 CTK 200 YD 45° | 100 | 200 | 1,5 | 4,129 | 3006508 |
| 100 CTK 250 YD 45° | 100 | 250 | 1,5 | 4,968 | 3006509 |
| 100 CTK 300 YD 45° | 100 | 300 | 1,5 | 6,534 | 3006510 |
| 100 CTK 400 YD 45° | 100 | 400 | 1,5 | 8,466 | 3006511 |
| 100 CTK 500 YD 45° | 100 | 500 | 1,5 | 11,251 | 3006512 |
| 100 CTK 600 YD 45° | 100 | 600 | 1,5 | 13,983 | 3006513 |

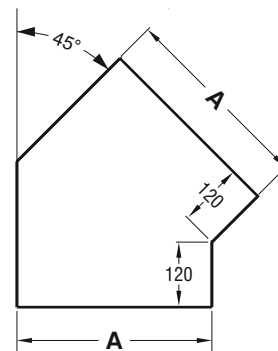
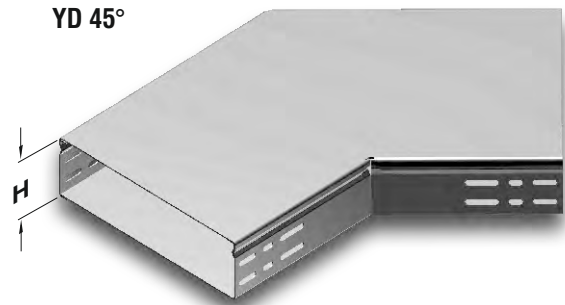

H=060 single row perforated.
H=075 two rows perforated.
H=100 three rows perforated.

Sample Order:
Height (H): 60 mm,
Width (A,B): 500 mm,
Sheet Thickness (T): 1,5 mm,
Coating Type (S): Hot Dip Galvanized,
Module Type: Flat Elbow Module 45°

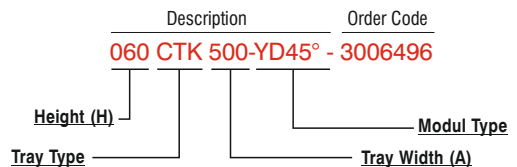

■ Please state the order code when ordering.

■ Material weights may vary by ± 10%

■ For special orders and specifications please contact us.

▶▶ CTK FLAT ELBOW MODULE (90°) Hot Dip Galvanized After Fabrication (TS EN ISO 1461)

| Description | H (mm) | A (mm) | T (mm) | Weight (kg/m) | Order Code |
|----------------|--------|--------|--------|---------------|------------|
| 060 CTK 100 YD | 60 | 100 | 1,5 | 3,023 | 3006514 |
| 060 CTK 150 YD | 60 | 150 | 1,5 | 4,187 | 3006515 |
| 060 CTK 200 YD | 60 | 200 | 1,5 | 5,506 | 3006516 |
| 060 CTK 250 YD | 60 | 250 | 1,5 | 6,974 | 3006517 |
| 060 CTK 300 YD | 60 | 300 | 1,5 | 8,593 | 3006518 |
| 060 CTK 400 YD | 60 | 400 | 1,5 | 12,286 | 3006519 |
| 060 CTK 500 YD | 60 | 500 | 1,5 | 16,583 | 3006520 |
| 060 CTK 600 YD | 60 | 600 | 1,5 | 21,427 | 3006521 |
| <hr/> | | | | | |
| 075 CTK 100 YD | 75 | 100 | 1,5 | 3,197 | 3006522 |
| 075 CTK 150 YD | 75 | 150 | 1,5 | 4,381 | 3006523 |
| 075 CTK 200 YD | 75 | 200 | 1,5 | 5,719 | 3006524 |
| 075 CTK 250 YD | 75 | 250 | 1,5 | 7,206 | 3006525 |
| 075 CTK 300 YD | 75 | 300 | 1,5 | 8,845 | 3006526 |
| 075 CTK 400 YD | 75 | 400 | 1,5 | 12,587 | 3006527 |
| 075 CTK 500 YD | 75 | 500 | 1,5 | 16,913 | 3006528 |
| 075 CTK 600 YD | 75 | 600 | 1,5 | 21,794 | 3006529 |
| <hr/> | | | | | |
| 100 CTK 100 YD | 100 | 100 | 1,5 | 3,501 | 3006530 |
| 100 CTK 150 YD | 100 | 150 | 1,5 | 4,719 | 3006531 |
| 100 CTK 200 YD | 100 | 200 | 1,5 | 6,089 | 3006532 |
| 100 CTK 250 YD | 100 | 250 | 1,5 | 7,609 | 3006533 |
| 100 CTK 300 YD | 100 | 300 | 1,5 | 9,280 | 3006534 |
| 100 CTK 400 YD | 100 | 400 | 1,5 | 13,076 | 3006535 |
| 100 CTK 500 YD | 100 | 500 | 1,5 | 17,477 | 3006536 |
| 100 CTK 600 YD | 100 | 600 | 1,5 | 22,424 | 3006537 |

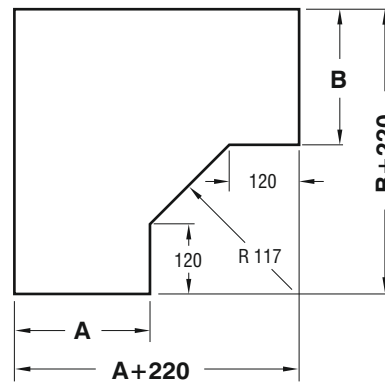
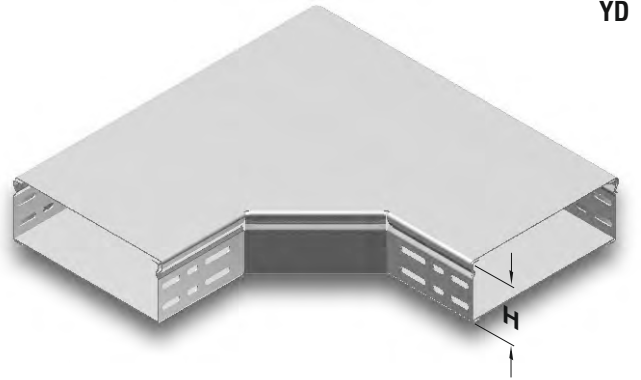

H=060 single row perforated.
H=075 two rows perforated.
H=100 three rows perforated.

Sample Order:
Height (H): 100 mm,
Width (A): 200 mm,
Sheet Thickness (T): 1,5 mm,
Coating Type (S): Hot Dip Galvanized,
Module Type: Flat Elbow Module 90°

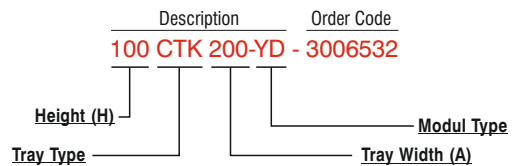

■ Please state the order code when ordering.

■ Material weights may vary by ± 10%

■ For special orders and specifications please contact us.

▶▶ CTK FLAT "T" MODULE

Hot Dip Galvanized After Fabrication (TS EN ISO 1461)

| Description | H (mm) | ABC (mm) | T (mm) | Weight (kg./pc.) | Order Code |
|----------------|--------|----------|--------|------------------|------------|
| 060 CTK 100 YT | 60 | 100 | 1,5 | 4,178 | 3006538 |
| 060 CTK 150 YT | 60 | 150 | 1,5 | 5,611 | 3006539 |
| 060 CTK 200 YT | 60 | 200 | 1,5 | 7,195 | 3006540 |
| 060 CTK 250 YT | 60 | 250 | 1,5 | 8,931 | 3006541 |
| 060 CTK 300 YT | 60 | 300 | 1,5 | 10,817 | 3006542 |
| 060 CTK 400 YT | 60 | 400 | 1,5 | 15,044 | 3006543 |
| 060 CTK 500 YT | 60 | 500 | 1,5 | 19,875 | 3006544 |
| 060 CTK 600 YT | 60 | 600 | 1,5 | 23,008 | 3006545 |
| 075 CTK 100 YT | 75 | 100 | 1,5 | 4,417 | 3006546 |
| 075 CTK 150 YT | 75 | 150 | 1,5 | 6,042 | 3006547 |
| 075 CTK 200 YT | 75 | 200 | 1,5 | 7,429 | 3006548 |
| 075 CTK 250 YT | 75 | 250 | 1,5 | 9,175 | 3006549 |
| 075 CTK 300 YT | 75 | 300 | 1,5 | 11,070 | 3006550 |
| 075 CTK 400 YT | 75 | 400 | 1,5 | 15,316 | 3006551 |
| 075 CTK 500 YT | 75 | 500 | 1,5 | 20,166 | 3006552 |
| 075 CTK 600 YT | 75 | 600 | 1,5 | 23,320 | 3006553 |
| 100 CTK 100 YT | 100 | 100 | 1,5 | 4,776 | 3006554 |
| 100 CTK 150 YT | 100 | 150 | 1,5 | 6,235 | 3006555 |
| 100 CTK 200 YT | 100 | 200 | 1,5 | 7,842 | 3006556 |
| 100 CTK 250 YT | 100 | 250 | 1,5 | 9,603 | 3006557 |
| 100 CTK 300 YT | 100 | 300 | 1,5 | 11,519 | 3006558 |
| 100 CTK 400 YT | 100 | 400 | 1,5 | 15,797 | 3006559 |
| 100 CTK 500 YT | 100 | 500 | 1,5 | 20,680 | 3006560 |
| 100 CTK 600 YT | 100 | 600 | 1,5 | 23,865 | 3006561 |

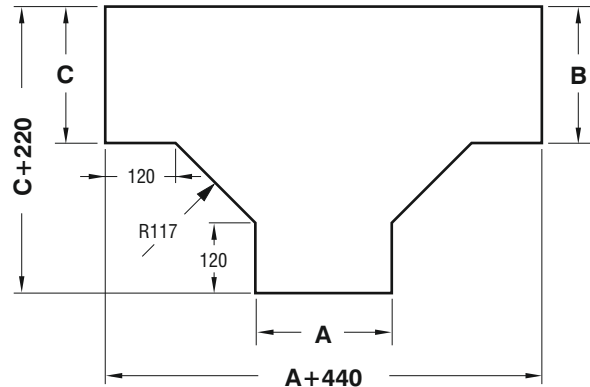
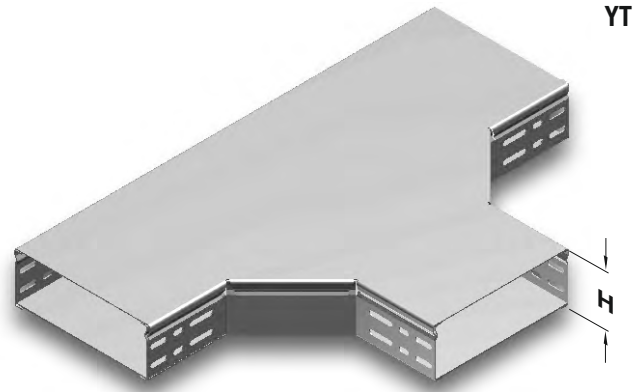

H=060 single row perforated.
H=075 two rows perforated.
H=100 three rows perforated.

Sample Order:
Height (H): 75 mm,
Width (A,B,C): 200 mm,
Sheet Thickness (T): 1,5 mm,
Coating Type (S): Hot Dip Galvanized,
Module Type: Flat "T" Module.

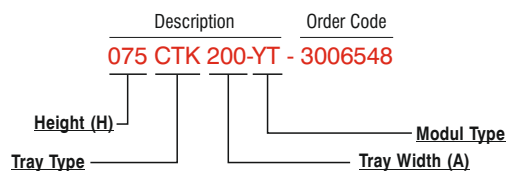

■ Please state the order code when ordering.

■ Material weights may vary by ± 10%

■ For special orders and specifications please contact us.

►► CTK FLAT 4 WAY INTERSECTION MODULE

Hot Dip Galvanized After Fabrication (TS EN ISO 1461)

| Description | H (mm) | ABCD (mm) | T (mm) | Weight (kg./pc.) | Order Code |
|----------------|--------|-----------|--------|------------------|------------|
| 060 CTK 100 AD | 60 | 100 | 1,5 | 5,057 | 3006562 |
| 060 CTK 150 AD | 60 | 150 | 1,5 | 7,086 | 3006563 |
| 060 CTK 200 AD | 60 | 200 | 1,5 | 8,938 | 3006564 |
| 060 CTK 250 AD | 60 | 250 | 1,5 | 10,941 | 3006565 |
| 060 CTK 300 AD | 60 | 300 | 1,5 | 13,093 | 3006566 |
| 060 CTK 400 AD | 60 | 400 | 1,5 | 17,854 | 3006567 |
| 060 CTK 500 AD | 60 | 500 | 1,5 | 23,219 | 3006568 |
| 060 CTK 600 AD | 60 | 600 | 1,5 | 29,189 | 3006569 |
| <hr/> | | | | | |
| 075 CTK 100 AD | 75 | 100 | 1,5 | 5,631 | 3006570 |
| 075 CTK 150 AD | 75 | 150 | 1,5 | 7,332 | 3006571 |
| 075 CTK 200 AD | 75 | 200 | 1,5 | 9,183 | 3006572 |
| 075 CTK 250 AD | 75 | 250 | 1,5 | 11,185 | 3006573 |
| 075 CTK 300 AD | 75 | 300 | 1,5 | 13,339 | 3006574 |
| 075 CTK 400 AD | 75 | 400 | 1,5 | 18,099 | 3006575 |
| 075 CTK 500 AD | 75 | 500 | 1,5 | 23,464 | 3006576 |
| 075 CTK 600 AD | 75 | 600 | 1,5 | 29,434 | 3006577 |
| <hr/> | | | | | |
| 100 CTK 100 AD | 100 | 100 | 1,5 | 6,074 | 3006578 |
| 100 CTK 150 AD | 100 | 150 | 1,5 | 7,774 | 3006579 |
| 100 CTK 200 AD | 100 | 200 | 1,5 | 9,625 | 3006580 |
| 100 CTK 250 AD | 100 | 250 | 1,5 | 11,628 | 3006581 |
| 100 CTK 300 AD | 100 | 300 | 1,5 | 13,782 | 3006582 |
| 100 CTK 400 AD | 100 | 400 | 1,5 | 18,542 | 3006583 |
| 100 CTK 500 AD | 100 | 500 | 1,5 | 23,906 | 3006584 |
| 100 CTK 600 AD | 100 | 600 | 1,5 | 29,876 | 3006585 |

Flat 4 Way Intersection Module

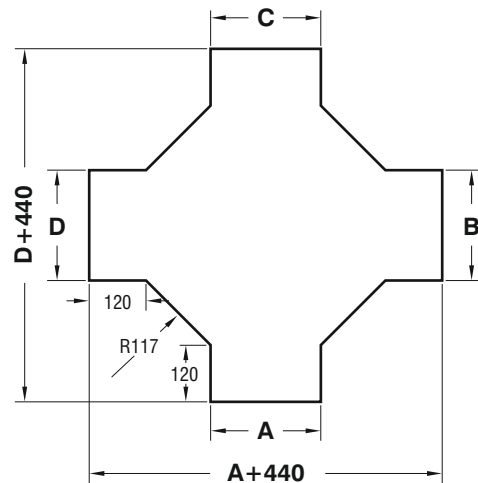
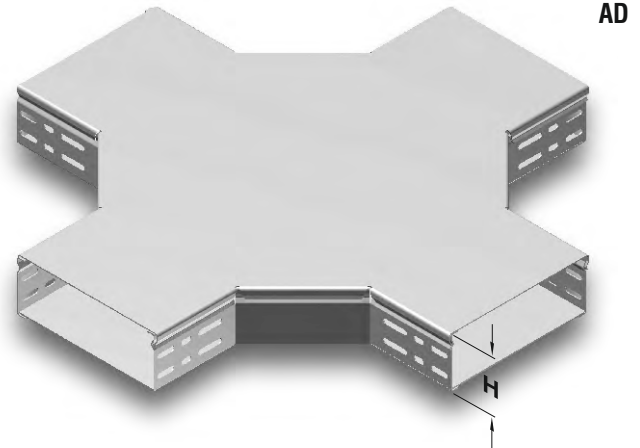

H=060 single row perforated.
H=075 two rows perforated.
H=100 three rows perforated.

Sample Order:

Height (H): 100 mm,

Width (A,B,C,D): 400 mm,

Sheet Thickness (T): 1,5 mm,

Coating Type (S): Hot Dip Galvanized,

Module Type: Flat 4 Way Intersection Module

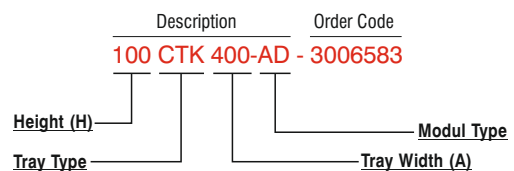

■ Please state the order code when ordering.

■ Material weights may vary by ± 10%

■ For special orders and specifications please contact us.

▶▶ CTK "T" CENTRE DESCENT MODULE

Hot Dip Galvanized After Fabrication (TS EN ISO 1461)

| Description | H (mm) | A (mm) | T (mm) | Weight (kg./pc.) | Order Code |
|----------------|--------|--------|--------|------------------|------------|
| 060 CTK 100 TO | 60 | 100 | 1,5 | 3,886 | 3006586 |
| 060 CTK 150 TO | 60 | 150 | 1,5 | 4,926 | 3006587 |
| 060 CTK 200 TO | 60 | 200 | 1,5 | 5,964 | 3006588 |
| 060 CTK 250 TO | 60 | 250 | 1,5 | 7,004 | 3006589 |
| 060 CTK 300 TO | 60 | 300 | 1,5 | 8,042 | 3006590 |
| 060 CTK 400 TO | 60 | 400 | 1,5 | 10,120 | 3006591 |
| 060 CTK 500 TO | 60 | 500 | 1,5 | 12,198 | 3006592 |
| 060 CTK 600 TO | 60 | 600 | 1,5 | 14,277 | 3006593 |
| <hr/> | | | | | |
| 075 CTK 100 TO | 75 | 100 | 1,5 | 4,105 | 3006594 |
| 075 CTK 150 TO | 75 | 150 | 1,5 | 5,144 | 3006595 |
| 075 CTK 200 TO | 75 | 200 | 1,5 | 6,183 | 3006596 |
| 075 CTK 250 TO | 75 | 250 | 1,5 | 7,222 | 3006597 |
| 075 CTK 300 TO | 75 | 300 | 1,5 | 8,261 | 3006598 |
| 075 CTK 400 TO | 75 | 400 | 1,5 | 10,339 | 3006599 |
| 075 CTK 500 TO | 75 | 500 | 1,5 | 12,417 | 3006600 |
| 075 CTK 600 TO | 75 | 600 | 1,5 | 14,495 | 3006601 |
| <hr/> | | | | | |
| 100 CTK 100 TO | 100 | 100 | 1,5 | 4,615 | 3006602 |
| 100 CTK 150 TO | 100 | 150 | 1,5 | 5,653 | 3006603 |
| 100 CTK 200 TO | 100 | 200 | 1,5 | 6,692 | 3006604 |
| 100 CTK 250 TO | 100 | 250 | 1,5 | 7,731 | 3006605 |
| 100 CTK 300 TO | 100 | 300 | 1,5 | 8,770 | 3006606 |
| 100 CTK 400 TO | 100 | 400 | 1,5 | 10,848 | 3006607 |
| 100 CTK 500 TO | 100 | 500 | 1,5 | 12,926 | 3006608 |
| 100 CTK 600 TO | 100 | 600 | 1,5 | 15,004 | 3006609 |

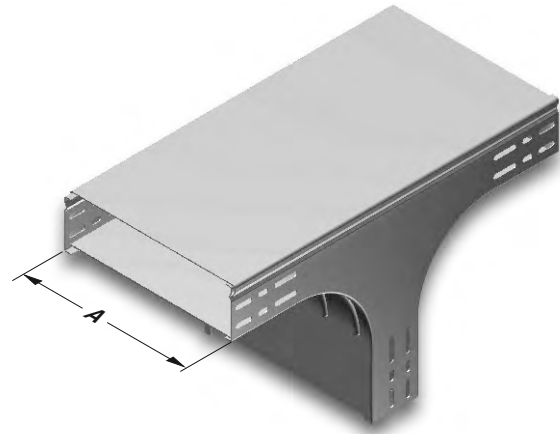

TO

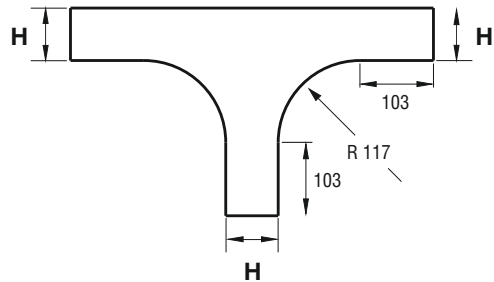

H=060 single row perforated.
 H=075 two rows perforated.
 H=100 three rows perforated.

Sample Order:
 Height (H): 75 mm,
 Width (A): 400 mm,
 Sheet Thickness (T): 1,5 mm,
 Coating Type (S): Hot Dip Galvanized,
 Module Type: "T" Centre

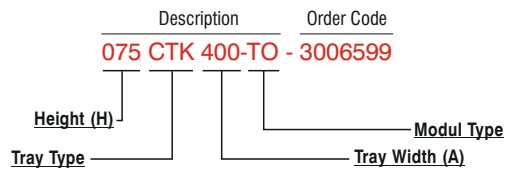

■ Please state the order code when ordering.

■ Material weights may vary by ± 10%

■ For special orders and specifications please contact us.

▶▶ CTK "T" WALL MOUNTED MODULE

Hot Dip Galvanized After Fabrication (TS EN ISO 1461)

| Description | H (mm) | A (mm) | B (mm) | T (mm) | Weight (kg./pc.) | Order Code |
|----------------|--------|--------|--------|--------|------------------|------------|
| 060 CTK 100 TD | 60 | 100 | 100 | 1,5 | 3,726 | 3006756 |
| 060 CTK 150 TD | 60 | 150 | 150 | 1,5 | 5,046 | 3006757 |
| 060 CTK 200 TD | 60 | 200 | 200 | 1,5 | 6,401 | 3006758 |
| 060 CTK 250 TD | 60 | 250 | 250 | 1,5 | 7,866 | 3006759 |
| 060 CTK 300 TD | 60 | 300 | 300 | 1,5 | 9,372 | 3006760 |
| 060 CTK 400 TD | 60 | 400 | 300 | 1,5 | 13,388 | 3006761 |
| 060 CTK 500 TD | 60 | 500 | 300 | 1,5 | 15,250 | 3006762 |
| 060 CTK 600 TD | 60 | 600 | 300 | 1,5 | 17,767 | 3006763 |
| 075 CTK 100 TD | 75 | 100 | 100 | 1,5 | 3,907 | 3006764 |
| 075 CTK 150 TD | 75 | 150 | 150 | 1,5 | 5,276 | 3006765 |
| 075 CTK 200 TD | 75 | 200 | 200 | 1,5 | 6,672 | 3006766 |
| 075 CTK 250 TD | 75 | 250 | 250 | 1,5 | 8,109 | 3006767 |
| 075 CTK 300 TD | 75 | 300 | 300 | 1,5 | 9,633 | 3006768 |
| 075 CTK 400 TD | 75 | 400 | 300 | 1,5 | 14,173 | 3006769 |
| 075 CTK 500 TD | 75 | 500 | 300 | 1,5 | 16,060 | 3006770 |
| 075 CTK 600 TD | 75 | 600 | 300 | 1,5 | 18,737 | 3006771 |
| 100 CTK 100 TD | 100 | 100 | 100 | 1,5 | 4,231 | 3006772 |
| 100 CTK 150 TD | 100 | 150 | 150 | 1,5 | 5,545 | 3006773 |
| 100 CTK 200 TD | 100 | 200 | 200 | 1,5 | 7,060 | 3006774 |
| 100 CTK 250 TD | 100 | 250 | 250 | 1,5 | 8,514 | 3006775 |
| 100 CTK 300 TD | 100 | 300 | 300 | 1,5 | 10,064 | 3006776 |
| 100 CTK 400 TD | 100 | 400 | 300 | 1,5 | 16,122 | 3006777 |
| 100 CTK 500 TD | 100 | 500 | 300 | 1,5 | 18,823 | 3006778 |
| 100 CTK 600 TD | 100 | 600 | 300 | 1,5 | 21,529 | 3006779 |

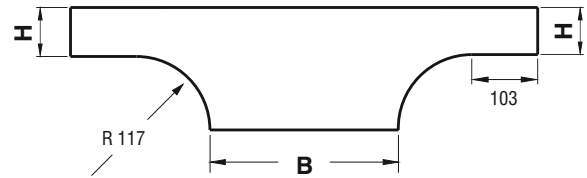

H=060 single row perforated.
 H=075 two rows perforated.
 H=100 three rows perforated.

Sample Order:
 Height (H): 100 mm,
 Width (A): 300 mm,
 Sheet Thickness (T): 1,5 mm,
 Coating Type (S): Hot Dip Galvanized,
 Module Type: "T" Wall Mounted Module

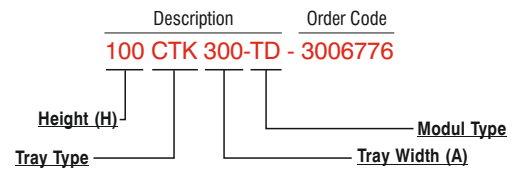

■ Please state the order code when ordering.

■ Material weights may vary by ± 10%

■ For special orders and specifications please contact us.

▶▶ CTK CONCAVE MODULE (90°)

Hot Dip Galvanized After Fabrication (TS EN ISO 1461)

| Description | H (mm) | A (mm) | T (mm) | Weight (kg./pc.) | Order Code |
|----------------|--------|--------|--------|------------------|------------|
| 060 CTK 100 ID | 60 | 100 | 1,5 | 2,122 | 3006708 |
| 060 CTK 150 ID | 60 | 150 | 1,5 | 2,674 | 3006709 |
| 060 CTK 200 ID | 60 | 200 | 1,5 | 3,225 | 3006710 |
| 060 CTK 250 ID | 60 | 250 | 1,5 | 3,777 | 3006711 |
| 060 CTK 300 ID | 60 | 300 | 1,5 | 4,330 | 3006712 |
| 060 CTK 400 ID | 60 | 400 | 1,5 | 5,433 | 3006713 |
| 060 CTK 500 ID | 60 | 500 | 1,5 | 5,924 | 3006714 |
| 060 CTK 600 ID | 60 | 600 | 1,5 | 7,150 | 3006715 |
| 075 CTK 100 ID | 75 | 100 | 1,5 | 2,325 | 3006716 |
| 075 CTK 150 ID | 75 | 150 | 1,5 | 2,893 | 3006717 |
| 075 CTK 200 ID | 75 | 200 | 1,5 | 3,462 | 3006718 |
| 075 CTK 250 ID | 75 | 250 | 1,5 | 4,029 | 3006719 |
| 075 CTK 300 ID | 75 | 300 | 1,5 | 4,598 | 3006720 |
| 075 CTK 400 ID | 75 | 400 | 1,5 | 5,733 | 3006721 |
| 075 CTK 500 ID | 75 | 500 | 1,5 | 6,870 | 3006722 |
| 075 CTK 600 ID | 75 | 600 | 1,5 | 8,006 | 3006723 |
| 100 CTK 100 ID | 100 | 100 | 1,5 | 2,701 | 3006724 |
| 100 CTK 150 ID | 100 | 150 | 1,5 | 3,295 | 3006725 |
| 100 CTK 200 ID | 100 | 200 | 1,5 | 3,887 | 3006726 |
| 100 CTK 250 ID | 100 | 250 | 1,5 | 4,481 | 3006727 |
| 100 CTK 300 ID | 100 | 300 | 1,5 | 5,075 | 3006728 |
| 100 CTK 400 ID | 100 | 400 | 1,5 | 6,263 | 3006729 |
| 100 CTK 500 ID | 100 | 500 | 1,5 | 7,451 | 3006730 |
| 100 CTK 600 ID | 100 | 600 | 1,5 | 8,639 | 3006731 |

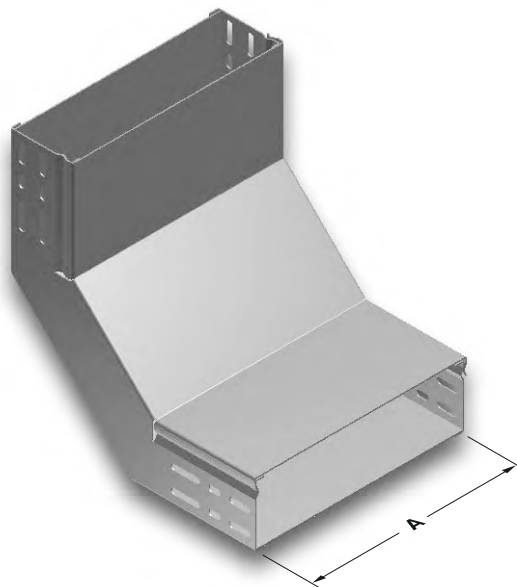

ID

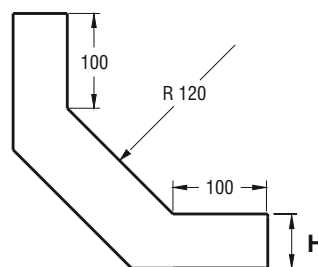

Sample Order:
 Height (H): 100 mm,
 Width (A): 300 mm,
 Sheet Thickness (T): 1,5 mm,
 Coating Type (S): Hot Dip Galvanized,
 Module Type: Concave Module.

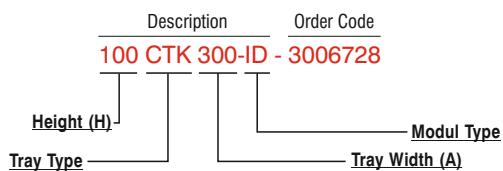

■ Please state the order code when ordering.

■ Material weights may vary by ± 10%

■ For special orders and specifications please contact us.

▶▶ CTK CONVEX MODULE (90°)

Hot Dip Galvanized After Fabrication (TS EN ISO 1461)

| Description | H (mm) | A (mm) | T (mm) | Weight (kg./pc.) | Order Code |
|----------------|--------|--------|--------|------------------|------------|
| 060 CTK 100 DD | 60 | 100 | 1,5 | 2,180 | 3006732 |
| 060 CTK 150 DD | 60 | 150 | 1,5 | 2,743 | 3006733 |
| 060 CTK 200 DD | 60 | 200 | 1,5 | 3,306 | 3006734 |
| 060 CTK 250 DD | 60 | 250 | 1,5 | 3,868 | 3006735 |
| 060 CTK 300 DD | 60 | 300 | 1,5 | 4,430 | 3006736 |
| 060 CTK 400 DD | 60 | 400 | 1,5 | 5,554 | 3006737 |
| 060 CTK 500 DD | 60 | 500 | 1,5 | 6,678 | 3006738 |
| 060 CTK 600 DD | 60 | 600 | 1,5 | 7,803 | 3006739 |
| <hr/> | | | | | |
| 075 CTK 100 DD | 75 | 100 | 1,5 | 2,329 | 3006740 |
| 075 CTK 150 DD | 75 | 150 | 1,5 | 2,892 | 3006741 |
| 075 CTK 200 DD | 75 | 200 | 1,5 | 3,454 | 3006742 |
| 075 CTK 250 DD | 75 | 250 | 1,5 | 4,016 | 3006743 |
| 075 CTK 300 DD | 75 | 300 | 1,5 | 4,578 | 3006744 |
| 075 CTK 400 DD | 75 | 400 | 1,5 | 5,702 | 3006745 |
| 075 CTK 500 DD | 75 | 500 | 1,5 | 6,827 | 3006746 |
| 075 CTK 600 DD | 75 | 600 | 1,5 | 7,951 | 3006747 |
| <hr/> | | | | | |
| 100 CTK 100 DD | 100 | 100 | 1,5 | 2,607 | 3006748 |
| 100 CTK 150 DD | 100 | 150 | 1,5 | 3,169 | 3006749 |
| 100 CTK 200 DD | 100 | 200 | 1,5 | 3,731 | 3006750 |
| 100 CTK 250 DD | 100 | 250 | 1,5 | 4,293 | 3006751 |
| 100 CTK 300 DD | 100 | 300 | 1,5 | 4,855 | 3006752 |
| 100 CTK 400 DD | 100 | 400 | 1,5 | 5,980 | 3006753 |
| 100 CTK 500 DD | 100 | 500 | 1,5 | 7,105 | 3006754 |
| 100 CTK 600 DD | 100 | 600 | 1,5 | 8,229 | 3006755 |

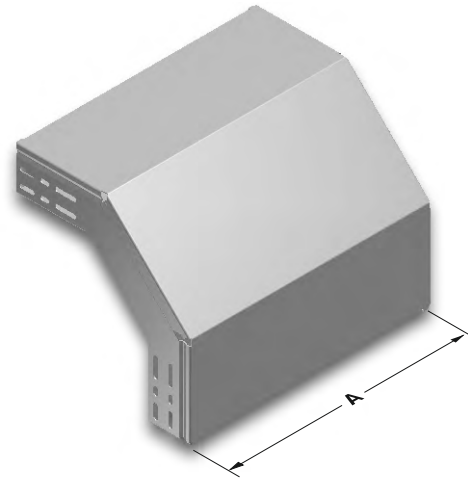

DD

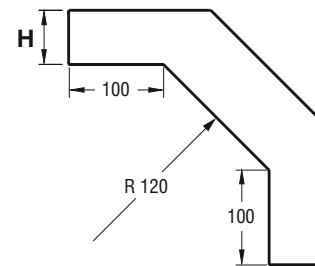

Sample Order:
 Height (H): 100 mm,
 Width (A): 200 mm,
 Sheet Thickness (T): 1,5 mm,
 Coating Type (S): Hot Dip Galvanized,
 Module Type: Convex Module.

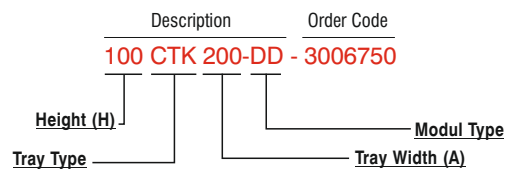

■ Please state the order code when ordering.

■ Material weights may vary by ± 10%

■ For special orders and specifications please contact us.

▶▶ CTK JOINT FITTING

Hot Dip Galvanized After Fabrication (TS EN ISO 1461)

| Description | H (mm) | T (mm) | Weight (kg./pc.) | Order Code |
|--------------------------|--------|--------|------------------|------------|
| 60 CTK JOINT FITTING | 40 | 2 | 0,191 | 3001965 |
| 75-100 CTK JOINT FITTING | 55,5 | 2 | 3007413 | |

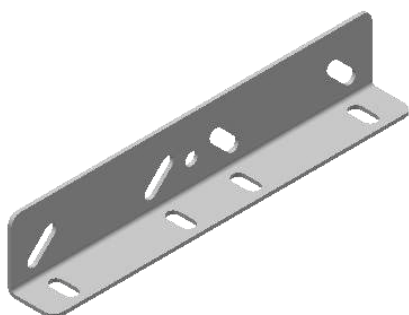

60 CTK CONNECTOR COMPONENT

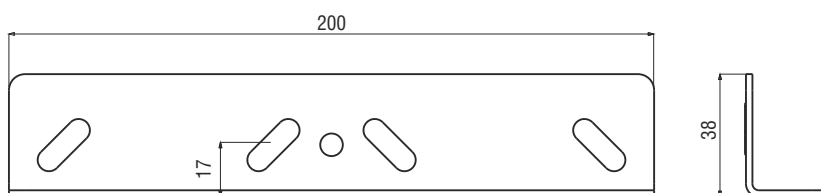

1 Unit of H=60 Connector Component; 4 units M6x12 bolts, 4 units M6 bolt nuts are used.



75-100 CTK CONNECTOR COMPONENT

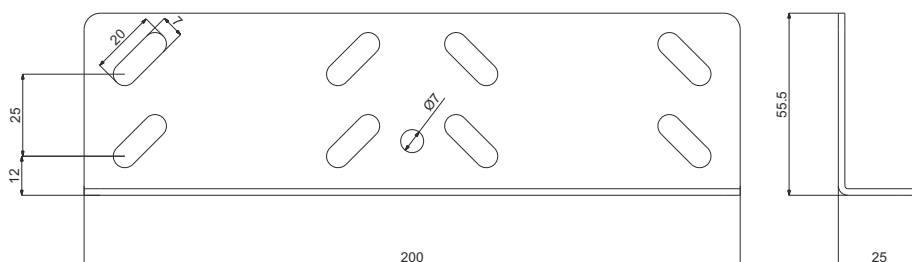

1 Unit of H=75-100 Connector Component; 8 units M6x12 bolts, 8 units M6 bolt nuts are used.

▶▶ CTK LEVEL ADAPTATION MODULE

Hot Dip Galvanized After Fabrication (TS EN ISO 1461)

| Description | H (mm) | A (mm) | T (mm) | Weight (kg./set.) | Order Code |
|-----------------|--------|--------|--------|-------------------|------------|
| 060 CTK 100 SDM | 60 | 100 | 1,5 | 5,997 | 3007285 |
| 060 CTK 150 SDM | 60 | 150 | 1,5 | 7,094 | 3007286 |
| 060 CTK 200 SDM | 60 | 200 | 1,5 | 8,190 | 3007287 |
| 060 CTK 250 SDM | 60 | 250 | 1,5 | 9,284 | 3007288 |
| 060 CTK 300 SDM | 60 | 300 | 1,5 | 10,377 | 3007289 |
| 060 CTK 400 SDM | 60 | 400 | 1,5 | 12,570 | 3007290 |
| 060 CTK 500 SDM | 60 | 500 | 1,5 | 14,760 | 3007291 |
| 060 CTK 600 SDM | 60 | 600 | 1,5 | 16,950 | 3007292 |
| <hr/> | | | | | |
| 075 CTK 100 SDM | 75 | 100 | 1,5 | 6,563 | 3007293 |
| 075 CTK 150 SDM | 75 | 150 | 1,5 | 7,659 | 3007294 |
| 075 CTK 200 SDM | 75 | 200 | 1,5 | 8,756 | 3007295 |
| 075 CTK 250 SDM | 75 | 250 | 1,5 | 9,849 | 3007296 |
| 075 CTK 300 SDM | 75 | 300 | 1,5 | 10,942 | 3007297 |
| 075 CTK 400 SDM | 75 | 400 | 1,5 | 13,135 | 3007298 |
| 075 CTK 500 SDM | 75 | 500 | 1,5 | 15,325 | 3007299 |
| 075 CTK 600 SDM | 75 | 600 | 1,5 | 17,515 | 3007300 |
| <hr/> | | | | | |
| 100 CTK 100 SDM | 100 | 100 | 1,5 | 7,366 | 3007301 |
| 100 CTK 150 SDM | 100 | 150 | 1,5 | 8,462 | 3007302 |
| 100 CTK 200 SDM | 100 | 200 | 1,5 | 9,559 | 3007303 |
| 100 CTK 250 SDM | 100 | 250 | 1,5 | 10,652 | 3007304 |
| 100 CTK 300 SDM | 100 | 300 | 1,5 | 11,745 | 3007305 |
| 100 CTK 400 SDM | 100 | 400 | 1,5 | 13,938 | 3007306 |
| 100 CTK 500 SDM | 100 | 500 | 1,5 | 16,128 | 3007307 |
| 100 CTK 600 SDM | 100 | 600 | 1,5 | 18,318 | 3007308 |

Grade Changing Module

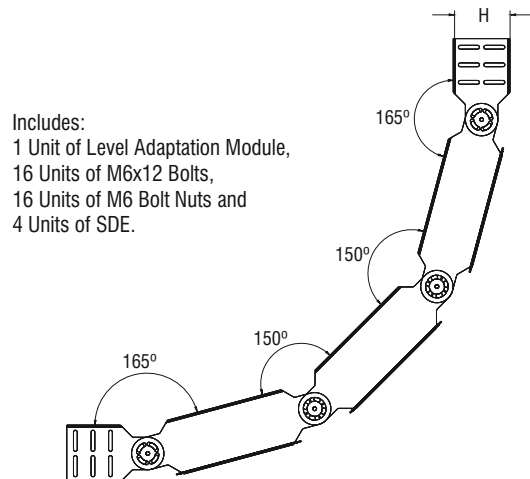
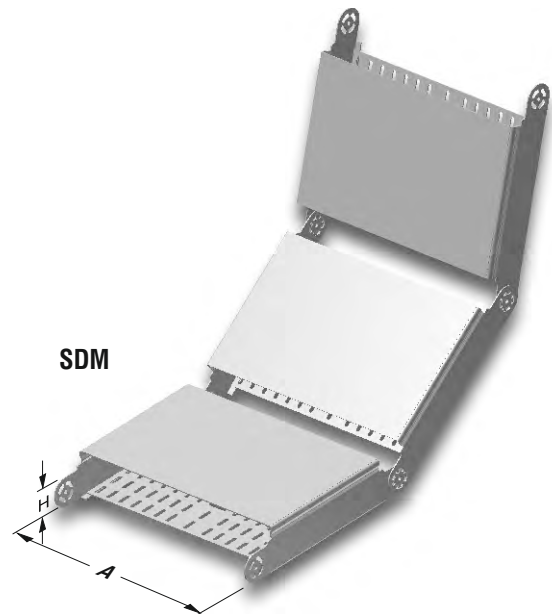

H=060 single row perforated.
H=075 two rows perforated.
H=100 three rows perforated.

Sample Order:
Height (H): 60 mm,
Width (A): 400 mm,
Sheet Thickness (T): 1,5 mm,
Coating Type (S): Hot Dip Galvanized,
Module Type: Level Adaptation Module

Description Order Code
060 CTK 400-SDM - 3007290



■ Please state the order code when ordering.

■ Material weights may vary by ± 10%

▶▶ CTK LEVEL ADAPTATION JOINT

Hot Dip Galvanized After Fabrication (TS EN ISO 1461)

| Description | H (mm) | T (mm) | Weight (kg./set.) | Order Code |
|-------------|--------|--------|-------------------|------------|
| 060 CTK SDE | 60 | 2 | 0,304 | 3007415 |
| 075 CTK SDE | 75 | 2 | 0,380 | 3007416 |
| 100 CTK SDE | 100 | 2 | 0,506 | 3007417 |

Level Adaptation Joint

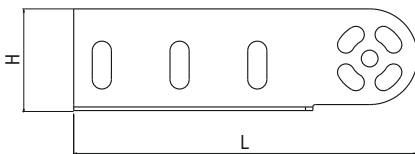
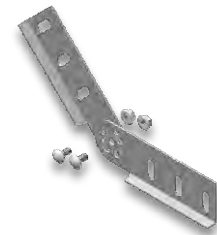

60/75/100 CT-SDE L=160

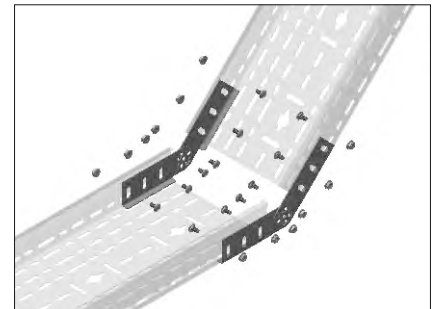

Includes: 4 units of grade changing components, 4 Units of M6x12 Bolts, 4 Units of M6 Bolt Nuts.

▶▶ CTK FLEXIBLE JOINT

Hot Dip Galvanized After Fabrication (TS EN ISO 1461)

| Description | H (mm) | T (mm) | Weight (kg./set.) | Order Code |
|--|--------|--------|-------------------|------------|
| 60 FLEXIBLE JOINT (100-150-200-250-300) | 53 | 1,2 | 0,354 | 3046731 |
| 60 FLEXIBLE JOINT (400-500-600) | 53 | 1,2 | 0,514 | 3046732 |
| 75 FLEXIBLE JOINT (100-150-200-250-300) | 64 | 1,2 | 0,466 | 3046733 |
| 75 FLEXIBLE JOINT (400-500-600) | 64 | 1,2 | 0,677 | 3046734 |
| 100 FLEXIBLE JOINT (100-150-200-250-300) | 94 | 1,2 | 0,638 | 3046735 |
| 100 FLEXIBLE JOINT (400-500-600) | 94 | 1,2 | 0,927 | 3046736 |

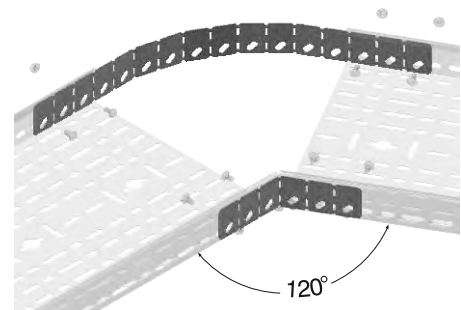

▶▶ CT SEPARATOR

Hot Dip Galvanized After Fabrication (TS EN ISO 1461)

| Description | H (mm) | T (mm) | Weight (kg./m.) | Order Code |
|------------------|--------|--------|-----------------|------------|
| 060 CT SEPARATOR | 55 | 1,2 | 0,833 | 3005833 |
| 075 CT SEPARATOR | 70 | 1,2 | 0,991 | 3006953 |
| 100 CT SEPARATOR | 95 | 1,2 | 1,271 | 3006952 |

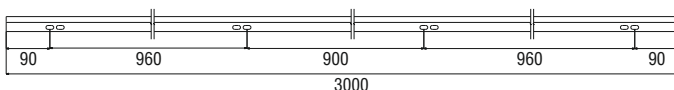
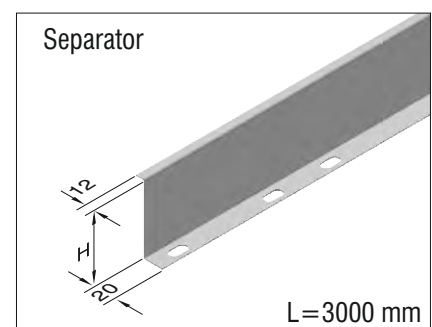

- Please state the order code when ordering.
- For special orders and specifications please contact us.
- Material weights may vary by $\pm 10\%$

▶▶ CTK LEFT-HAND REDUCTION

Hot Dip Galvanized After Fabrication (TS EN ISO 1461)

| Description | H (mm) | A (mm) | T (mm) | Weight (kg./pc.) | Order Code |
|---------------|--------|--------|--------|------------------|------------|
| 60 CTK RD 50 | 60 | 50 | 2 | 0,187 | 3007358 |
| 60 CTK RD100 | 60 | 100 | 2 | 0,229 | 3007359 |
| 60 CTK RD150 | 60 | 150 | 2 | 0,271 | 3007360 |
| 60 CTK RD200 | 60 | 200 | 2 | 0,312 | 3007361 |
| 60 CTK RD250 | 60 | 250 | 2 | 0,355 | 3007362 |
| 60 CTK RD300 | 60 | 300 | 2 | 0,397 | 3007363 |
| 75 CTK RD 50 | 75 | 50 | 2 | 0,238 | 3007364 |
| 75 CTK RD100 | 75 | 100 | 2 | 0,293 | 3007365 |
| 75 CTK RD150 | 75 | 150 | 2 | 0,348 | 3007366 |
| 75 CTK RD200 | 75 | 200 | 2 | 0,403 | 3007367 |
| 75 CTK RD250 | 75 | 250 | 2 | 0,458 | 3007368 |
| 75 CTK RD300 | 75 | 300 | 2 | 0,513 | 3007369 |
| 100 CTK RD 50 | 100 | 50 | 2 | 0,329 | 3007370 |
| 100 CTK RD100 | 100 | 100 | 2 | 0,406 | 3007371 |
| 100 CTK RD150 | 100 | 150 | 2 | 0,483 | 3007372 |
| 100 CTK RD200 | 100 | 200 | 2 | 0,559 | 3007373 |
| 100 CTK RD250 | 100 | 250 | 2 | 0,636 | 3007374 |
| 100 CTK RD300 | 100 | 300 | 2 | 0,713 | 3007375 |

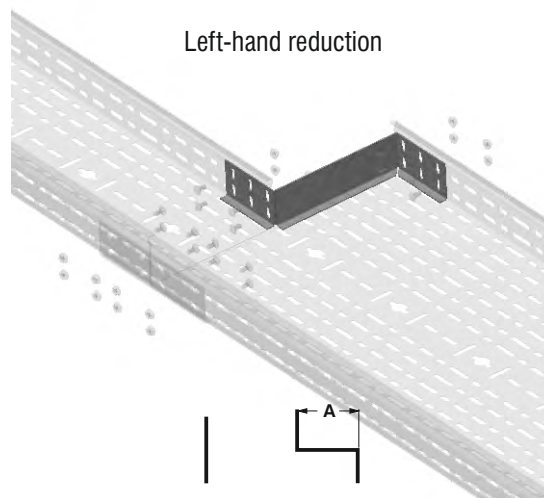

H=060 single row perforated.
H=075 two rows perforated.
H=100 three rows perforated.

Sample Order:
Height (H): 40 mm,
Width (A): 100 mm,
Sheet Thickness (T): 2 mm,
Coating Type (S): Hot Dip Galvanized,
Module Type: Left-hand reduction.

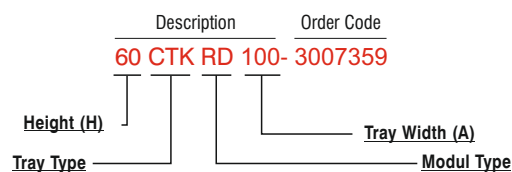

- Please state the order code when ordering.
- For special orders and specifications please contact us.
- Material weights may vary by ± 10%

▶▶ CTK RIGHT-HAND REDUCTION

Hot Dip Galvanized After Fabrication (TS EN ISO 1461)

| Description | H (mm) | A (mm) | T (mm) | Weight (kg./pc.) | Order Code |
|---------------|--------|--------|--------|------------------|------------|
| 60 CTK RD 50 | 60 | 50 | 2 | 0,187 | 3007376 |
| 60 CTK RD100 | 60 | 100 | 2 | 0,229 | 3007377 |
| 60 CTK RD150 | 60 | 150 | 2 | 0,271 | 3007378 |
| 60 CTK RD200 | 60 | 200 | 2 | 0,312 | 3007379 |
| 60 CTK RD250 | 60 | 250 | 2 | 0,355 | 3007380 |
| 60 CTK RD300 | 60 | 300 | 2 | 0,397 | 3007381 |
| 75 CTK RD 50 | 75 | 50 | 2 | 0,238 | 3007382 |
| 75 CTK RD100 | 75 | 100 | 2 | 0,293 | 3007383 |
| 75 CTK RD150 | 75 | 150 | 2 | 0,348 | 3007384 |
| 75 CTK RD200 | 75 | 200 | 2 | 0,403 | 3007385 |
| 75 CTK RD250 | 75 | 250 | 2 | 0,458 | 3007386 |
| 75 CTK RD300 | 75 | 300 | 2 | 0,513 | 3007387 |
| 100 CTK RD 50 | 100 | 50 | 2 | 0,329 | 3007388 |
| 100 CTK RD100 | 100 | 100 | 2 | 0,406 | 3007389 |
| 100 CTK RD150 | 100 | 150 | 2 | 0,483 | 3007390 |
| 100 CTK RD200 | 100 | 200 | 2 | 0,559 | 3007391 |
| 100 CTK RD250 | 100 | 250 | 2 | 0,636 | 3007392 |
| 100 CTK RD300 | 100 | 300 | 2 | 0,713 | 3007393 |

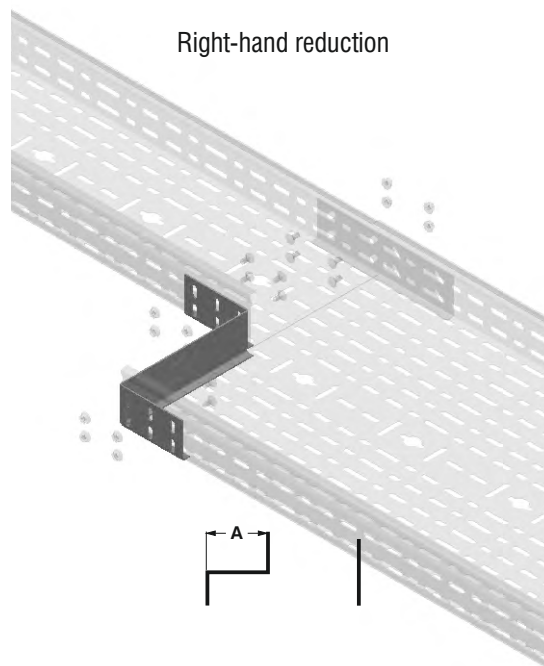

H=060 single row perforated.
H=075 two rows perforated.
H=100 three rows perforated.

Sample Order:
Height (H): 60 mm,
Width (A): 100 mm,
Sheet Thickness (T): 2 mm,
Coating Type (S): Hot Dip Galvanized,
Module Type: Right-hand reduction

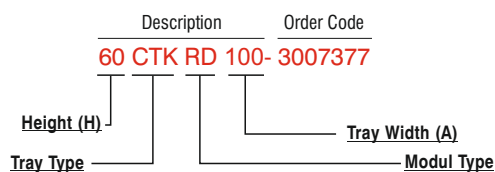

- Please state the order code when ordering.
- For special orders and specifications please contact us.
- Material weights may vary by ± 10%

▶▶ CTK CENTRE REDUCTION

Hot Dip Galvanized After Fabrication (TS EN ISO 1461)

| Description | H (mm) | A (mm) | T (mm) | Weight (kg./set.) | Order Code |
|---------------|--------|--------|--------|-------------------|------------|
| 60 CTK RD 50 | 60 | 50 | 2 | 0,374 | 3007394 |
| 60 CTK RD100 | 60 | 100 | 2 | 0,458 | 3007395 |
| 60 CTK RD150 | 60 | 150 | 2 | 0,541 | 3007396 |
| 60 CTK RD200 | 60 | 200 | 2 | 0,625 | 3007397 |
| 60 CTK RD250 | 60 | 250 | 2 | 0,711 | 3007398 |
| 60 CTK RD300 | 60 | 300 | 2 | 0,794 | 3007399 |
| <hr/> | | | | | |
| 75 CTK RD 50 | 75 | 50 | 2 | 0,475 | 3007400 |
| 75 CTK RD100 | 75 | 100 | 2 | 0,585 | 3007401 |
| 75 CTK RD150 | 75 | 150 | 2 | 0,695 | 3007402 |
| 75 CTK RD200 | 75 | 200 | 2 | 0,805 | 3007403 |
| 75 CTK RD250 | 75 | 250 | 2 | 0,915 | 3007404 |
| 75 CTK RD300 | 75 | 300 | 2 | 1,025 | 3007405 |
| <hr/> | | | | | |
| 100 CTK RD 50 | 100 | 50 | 2 | 0,658 | 3007406 |
| 100 CTK RD100 | 100 | 100 | 2 | 0,812 | 3007407 |
| 100 CTK RD150 | 100 | 150 | 2 | 0,966 | 3007408 |
| 100 CTK RD200 | 100 | 200 | 2 | 1,118 | 3007409 |
| 100 CTK RD250 | 100 | 250 | 2 | 1,272 | 3007410 |
| 100 CTK RD300 | 100 | 300 | 2 | 1,426 | 3007411 |

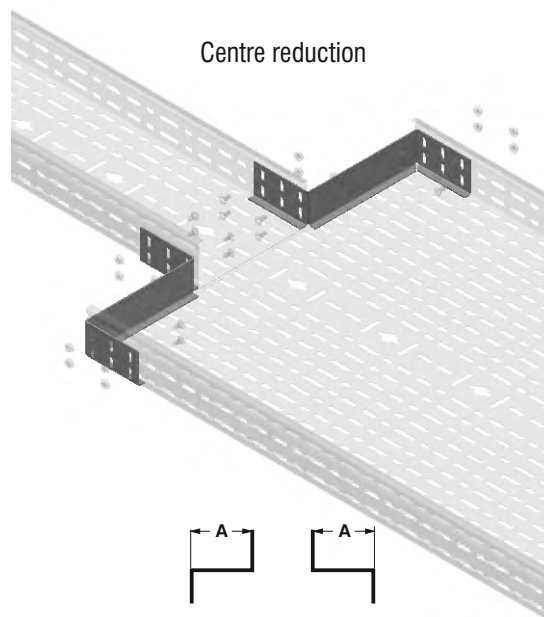

H=060 single row perforated.
H=075 two rows perforated.
H=100 three rows perforated.

Sample Order:
Height (H): 75 mm,
Width (A): 100 mm,
Sheet Thickness (T): 2 mm,
Coating Type (S): Hot Dip Galvanized,
Module Type: Centre reduction.

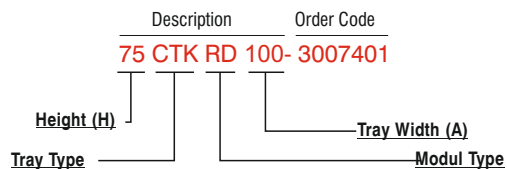

- Please state the order code when ordering.
- For special orders and specifications please contact us.
- Material weights may vary by ± 10%

▶▶ CTK END COVER

Hot Dip Galvanized After Fabrication (TS EN ISO 1461)

| Description | H (mm) | A (mm) | T (mm) | Weight (kg./pc.) | Order Code |
|-------------|--------|--------|--------|------------------|------------|
| 060 CTK 100 | 62 | 106 | 1,5 | 0,222 | 3049183 |
| 060 CTK 150 | 62 | 156 | 1,5 | 0,268 | 3049184 |
| 060 CTK 200 | 62 | 206 | 1,5 | 0,315 | 3049185 |
| 060 CTK 250 | 62 | 256 | 1,5 | 0,361 | 3049186 |
| 060 CTK 300 | 62 | 306 | 1,5 | 0,407 | 3049187 |
| 060 CTK 400 | 62 | 406 | 1,5 | 0,501 | 3049188 |
| 060 CTK 500 | 62 | 506 | 1,5 | 0,593 | 3049189 |
| 060 CTK 600 | 62 | 606 | 1,5 | 0,685 | 3049190 |
| <hr/> | | | | | |
| 075 CTK 100 | 77 | 106 | 1,5 | 0,276 | 3049191 |
| 075 CTK 150 | 77 | 156 | 1,5 | 0,332 | 3049192 |
| 075 CTK 200 | 77 | 206 | 1,5 | 0,388 | 3049193 |
| 075 CTK 250 | 77 | 256 | 1,5 | 0,444 | 3049194 |
| 075 CTK 300 | 77 | 306 | 1,5 | 0,501 | 3049195 |
| 075 CTK 400 | 77 | 406 | 1,5 | 0,613 | 3049196 |
| 075 CTK 500 | 77 | 506 | 1,5 | 0,725 | 3049197 |
| 075 CTK 600 | 77 | 606 | 1,5 | 0,837 | 3049198 |
| <hr/> | | | | | |
| 100 CTK 100 | 102 | 106 | 1,5 | 0,372 | 3049199 |
| 100 CTK 150 | 102 | 156 | 1,5 | 0,444 | 3049200 |
| 100 CTK 200 | 102 | 206 | 1,5 | 0,516 | 3049201 |
| 100 CTK 250 | 102 | 256 | 1,5 | 0,589 | 3049202 |
| 100 CTK 300 | 102 | 306 | 1,5 | 0,661 | 3049203 |
| 100 CTK 400 | 102 | 406 | 1,5 | 0,805 | 3049204 |
| 100 CTK 500 | 102 | 506 | 1,5 | 0,949 | 3049205 |
| 100 CTK 600 | 102 | 606 | 1,5 | 1,095 | 3049206 |

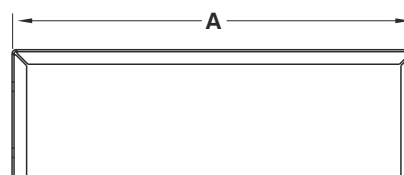
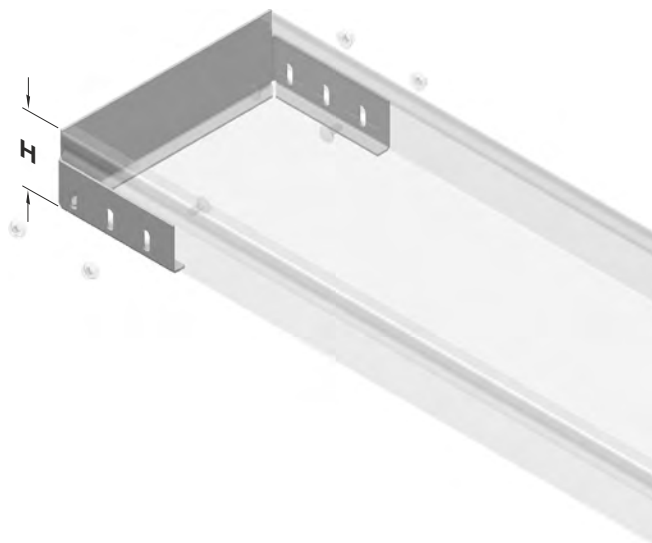

Sample Order:

| | |
|-------------|------------|
| Description | Order Code |
| 100 CTK 400 | - 3049204 |



- Please state the order code when ordering.
- For special orders and specifications please contact us.
- Material weights may vary by ± 10%