

EXIT WALD

2 W Emergency Lighting LED Luminaire

Order Code : 3203685
Product Code : EXT 002A 65LN02 150 20 WLD STD YV FLP



Product Data

Standard Features

Housing	: White Polycarbonate Housing
IP Grade	: IP20
Installation	: Recessed Mounted
Light Source	: Power LED
Emergency Kit Options	: 1 - 3 Hours
Run Mode	: Non maintained

Optical & Electrical Features

Power Consumption	: 2 W
Final Luminous Flux	: 136 lm
Efficacy	: 68 lm/W
Input Voltage	: 220-240 V AC
Frequency	: 50-60 Hz
Power Factor	: $\cos \phi > 0,9$
Correlated Color Temperature	: 6500K
Color Rendering Index	: >80

* There is $\pm 10\%$ Tolerance in Technical Values.

Other Features & Conditions

Operating Temperature Range With Emergency Kit	: +10 °C / +35 °C
Impact Resistance	: IK02
Led Life Time - L70	: > 50.000 hours @Ta= 35 °C

Photometric Curve

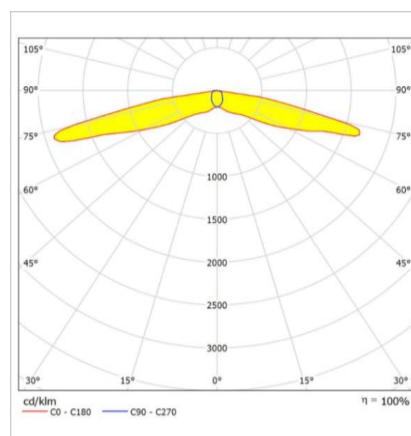

Optional Features

Electronic Control : Self/Test, DALI

EXIT WALD

2 W Emergency Lighting LED Luminaire

3203685 EXT 002A 65LN02 150 20 WLD STD YV FLP

Dimensions (mm)

	\emptyset	h	$\emptyset D$
Standard	82	22	72

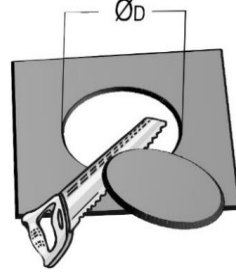
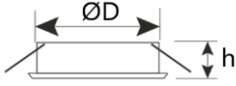
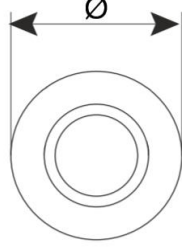

Weight (gr)

Standard	600
----------	-----

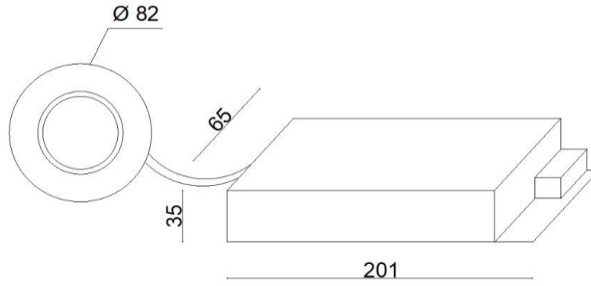

- The device needs to be charged and discharged for 48 hours twice. After the third 48-hour charge, it will run for 3 hours.
- EAE, reserves the right to make changes without prior notice.

engineering the light

EAE Aydınlatma A.Ş.
İkitelli Organize Sanayi Bölgesi Eski Turgut Özal Caddesi No:20 Başakşehir / İSTANBUL-TURKEY
Phone: +90 212 413 21 00 (pbx) Fax: +90 212 549 37 90
www.eaeaydinlatma.com.tr

Revision date: 18.03.2024